

NOTES: (XX)

- 1. EXISTING STRUCTURE
- 2. EXISTING LOCATION OF STAFF PARKING 2.5 X 5.5 16 SLOTS.
- 3. HARDSTAND DRIVEWAY TBC BY CLIENT.
- 4. SEWER EASSEMENT.
- 5. EXISTING 250 000L RAINWATER DETENTION TANK OUTFLOW TO BERRYS LANE.
- 6. EXISTING FIRE HYDRANT. EXACT LOCATION TO BE CONFIRMED ON SITE.
- 7. EXISTING STREET HYDRANT EXACT LOCATION TO BE CONFIRMED ON SITE.
- 8. EXISTING WATER METER EXACT LOCATION TO BE CONFIRMED ON SITE.
- 9. EXISTING BOUNDARY TO BE REMOVED. LOTS TO BE CONSOLIDATED.

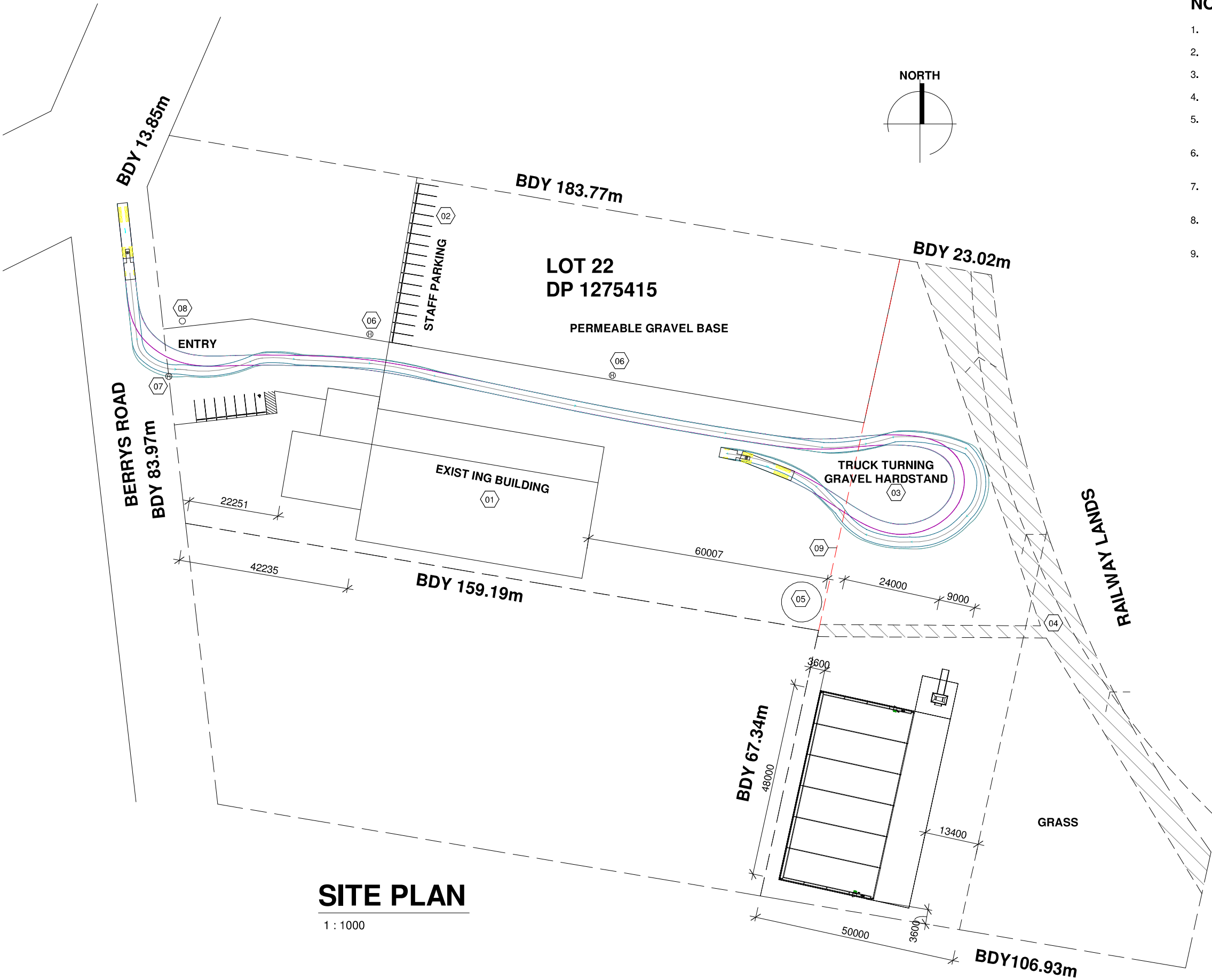

SITE PLAN

1 : 1000



WARRICK MORLEY  
DRAFTING SERVICES

A | 'Greenwood' Bimbi NSW 2810 M | 0423 380 735 E | warrick@wmdrafting.com

PROPOSED FERTILIZER SHED  
13, BERRYS ROAD, GRENFELL, NSW  
CONRON GROUP

COPYRIGHT No part of this drawing, information or data documented maybe copied or reproduced without prior permission from Warrick Morley Drafting Services.

SCALE As indicated  
DATE 28/02/2025  
DRAWN CM  
DESIGNED WM

REVISION  
1 PRELIMINARY ISSUE  
2 HYDRANT LOCATIONS  
3 MOVED SITE LOCATION

DATE  
28/02/2025  
04/03/2025  
22/05/2025

PROJECT No.  
W25003  
SHEET  
A001

DA SUBMISSION